



Serrature da infilare a cilindro | Scatola Chiusa | Stile LIBERTY e ARABIC

Mortice locks for profile cylinder | Closed Lock Case | LIBERTY and ARABIC style



3200
Elite

Elite

S.A.B.

Gli Ornamenti

Le lavorazioni artigianali dei Maestri Incisori

La serie *Elite* e *Luxury* sono caratterizzate da lavorazioni artigianali proprie dei Maestri Incisori che ancor oggi tramandano di padre in figlio l'antica arte del bulino e da secoli sapientemente impreziosiscono e rendono unici prodotti come armi e oggetti di oreficeria, destinati ad appassionati e collezionisti di tutto il mondo.

Le diverse ornamentazioni dei raffinati motivi **Liberty** e **Arabic** vengono e videnziate dalle varie finiture della piastra incisa, ma trovano la loro massima esaltazione nella serie *Luxury*, dove la precisa mano dell'artigiano posa nell'incisione foglie d'oro nei vari colori, trasformando con la personalità propria dell'artista un oggetto "comune" ed inusuale in un'autentica opera d'arte.

The Ornaments

The ancient art of Master Chisellers

Locks variety *Elite* and *Luxury* are characterized from artisan working typical of Masters Chisellers that for ages enriched and made unique products like hunting guns or jeweller's wares destined worldwide collectors.

Today the fine art of engraving is still transmitted from father to son.

Refined ornaments of **Liberty** and **Arabic** style are marked from the several finishings of the brass plate, but find the maximum exaltation in *Luxury* series where the precise artisan's silky hands lovingly place gold powder in different colours that transform a "standard" and "unusual" product in a really "piece of art".





Arabic

White



Liberty





Elite

3200 ELITÉ - LIBERTY

Catenaccio e Scrocco | Catenaccio Antistrappo e Scrocco
 Rullo Registrabile
 1-2 Mandate
 Azionamento a cilindro, quadro 8 o chiave patent

Bolt and latch | Tamper Proof Bolt and latch
 Adjustable roller
 1-2 Turns
 Cylinder movement, Square 8 or Patent Key

Piastra frontale con incisione Stile LIBERTY

Frontal plate with LIBERTY Style Engraving

FINITURA DI SERIE

STANDARD FINISHINGS

- Piastra frontale, Catenaccio, Scrocco o Rullo OLV

- Front plate, Bolt, Latch or Roller OLV

DOTAZIONE

ACCESSORIES

- Contropiastra con aletta Art. 357 OLV
- Vaschetta coprifresata scrocco e catenaccio Art. C371
- Viti di fissaggio
- CILINDRO ESCLUSO

- Striking plate with tab Art. 357 OLV
- Plastic bolt and latch milling cover Art. C371
- Fixing screws
- CYLINDER NOT INCLUDED

Serie 3200 Elité - LIBERTY



Serrature da infilare a cilindro | Scatola Chiusa | Stile LIBERTY
 Mortice locks for profile cylinder | Closed lock case | LIBERTY Style

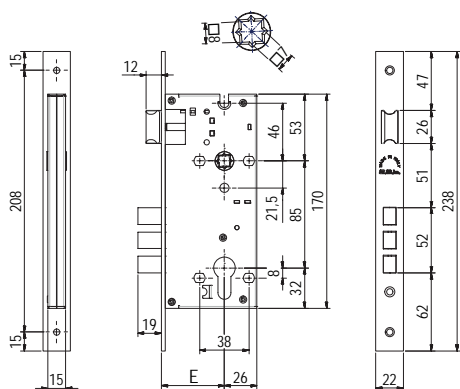

L3200/85
L3205/85

Catenaccio Antistrappo e Scrocco | 1-2 Mandate | Azionamento a cilindro | Incisione Stile LIBERTY
 Tamper proof bolt and latch | 1-2 Turns | Cylinder movement | LIBERTY Style Engraving

Codice Code	Finitura Finishing						
L3200 85 45 ___ 7	---						
L3200 85 50 ___ 7	---						
L3200 85 60 ___ 7	---	2					
L3200 85 70 ___ 7	---						
L3200 85 80 ___ 7	---						
L3205 85 45 ___ 7	---		22x3x238	85			1 20
L3205 85 50 ___ 7	---						
L3205 85 60 ___ 7	---	1					
L3205 85 70 ___ 7	---						
L3205 85 80 ___ 7	---						

Finiture Standard | Standard Finishings

Finitura Finishing	OLV	PLO	OPM	OCL ONS	OGM

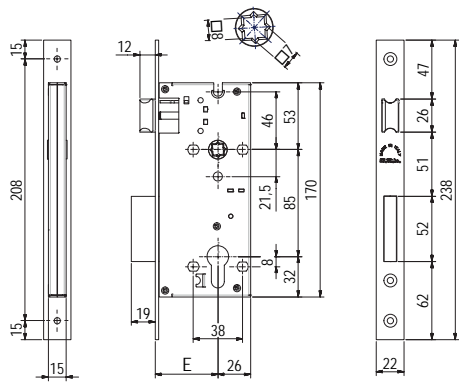

L3210/85
L3215/85

Catenaccio e Scrocco | 1-2 Mandate | Azionamento a cilindro | Incisione Stile LIBERTY

Bolt and Latch | 1-2 Turns | Cylinder movement | LIBERTY Style Engraving

Codice Code	Finitura Finishing					
L3210 85 40 ___ 7	---					40
L3210 85 45 ___ 7	---					45
L3210 85 50 ___ 7	---					50
L3210 85 60 ___ 7	---	2				60
L3210 85 70 ___ 7	---					70
L3210 85 80 ___ 7	---					80
L3215 85 40 ___ 7	---		22x3x238	85		40
L3215 85 45 ___ 7	---					45
L3215 85 50 ___ 7	---					50
L3215 85 60 ___ 7	---	1				60
L3215 85 70 ___ 7	---					70
L3215 85 80 ___ 7	---					80

Finiture Standard | Standard Finisings

Finitura Finishing	OLV	PLO	OPM	OCL ONS	OGM

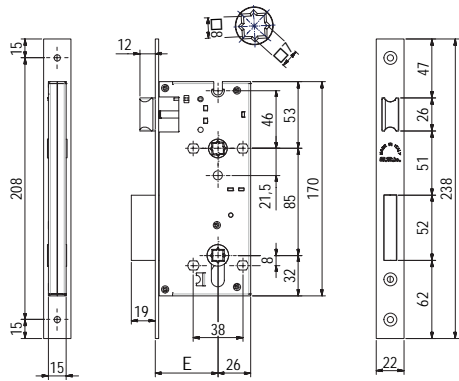

L3216/85

Serratura per bagno | Doppio quadro 8mm | Catenaccio e Scrocco | 1 Mandata | Azionamento quadro 8mm | Incisione Stile LIBERTY

Bathroom lock | Double square hole 8mm | Bolt and Latch | 1 Turn | Square hole movement | LIBERTY Style Engraving

Codice Code	Finitura Finishing					
L3216 85 40 ___ 7	---					40
L3216 85 45 ___ 7	---					45
L3216 85 50 ___ 7	---	1	22x3x238	85		50
L3216 85 60 ___ 7	---					60
L3216 85 70 ___ 7	---					70
L3216 85 80 ___ 7	---					80

Finiture Standard | Standard Finisings

Finitura Finishing	OLV	PLO	OPM	OCL ONS	OGM

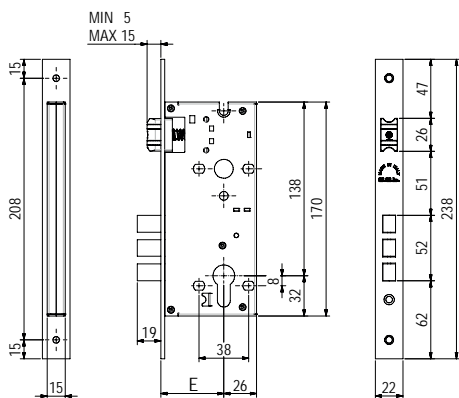

L3202
L3207

Catenaccio Antistrappo | Rullo registrabile | 1-2 Mandate | Azionamento a cilindro | Incisione Stile LIBERTY

Tamper proof bolt | Adjustable roller | 1-2 Turns | Cylinder movement | LIBERTY Style Engraving

Codice Code	Finitura Finishing					
L3202 45 ___ 7	---					45
L3202 50 ___ 7	---					50
L3202 60 ___ 7	---	2				60
L3202 70 ___ 7	---					70
L3202 80 ___ 7	---					80
L3207 45 ___ 7	---		22x3x238			45
L3207 50 ___ 7	---					50
L3207 60 ___ 7	---	1				60
L3207 70 ___ 7	---					70
L3207 80 ___ 7	---					80

Finiture Standard | Standard Finisings

Finitura Finishing	OLV	PLO	OPM	OCL ONS	OGM

Serie
3200 Elitè - LIBERTY



Serrature da infilare a cilindro | Scatola Chiusa | Stile LIBERTY
Mortice locks for profile cylinder | Closed lock case | LIBERTY Style

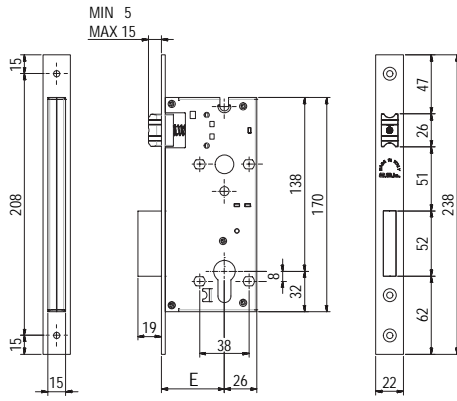

L3212
L3217

Catenaccio | Rullo registrabile | 1-2 Mandate | Azionamento a cilindro | Incisione Stile LIBERTY

Bolt | Adjustable roller | 1-2 Turns | Cylinder movement | LIBERTY Style Engraving

Codice Code	Finitura Finishing					
L3212 40 ___ 7	---					40
L3212 45 ___ 7	---					45
L3212 50 ___ 7	---					50
L3212 60 ___ 7	---					60
L3212 70 ___ 7	---					70
L3212 80 ___ 7	---					80
L3217 40 ___ 7	---					40
L3217 45 ___ 7	---					45
L3217 50 ___ 7	---					50
L3217 60 ___ 7	---					60
L3217 70 ___ 7	---					70
L3217 80 ___ 7	---					80

2

22x3x238

1

20

Finiture Standard | Standard Finishings

Finitura Finishing	OLV	PLO	OPM	OCL ONS	OGM

Versioni Speciali / Special Type

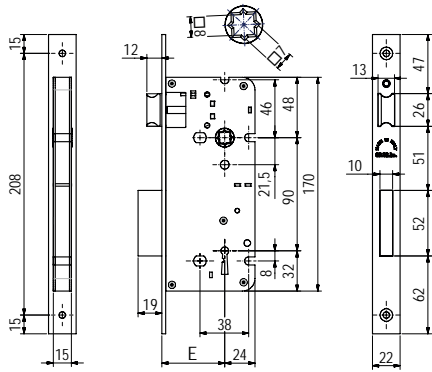

L2260/90
L2265/90

Catenaccio e Scrocco | 1-2 Mandate | Azionamento con Chiave Patent | Incisione Stile LIBERTY

Bolt and Latch | 1-2 Turns | Patent Key movement | LIBERTY Style Engraving

Codice Code	Finitura Finishing					
L2260 90 40 ___ 7	---					40
L2260 90 45 ___ 7	---					45
L2260 90 50 ___ 7	---					50
L2260 90 60 ___ 7	---					60
L2265 90 40 ___ 7	---					40
L2265 90 45 ___ 7	---					45
L2265 90 50 ___ 7	---					50
L2265 90 60 ___ 7	---					60

2

22x3x238

90

1

20

* Gli articoli L2260-L2265 sono solo con scatola aperta | Articles L2260-L2265 are available only with open lock case

Finiture Standard | Standard Finishings

Finitura Finishing	OLV	PLO	OPM	OCL ONS	OGM

Finiture
Finishings

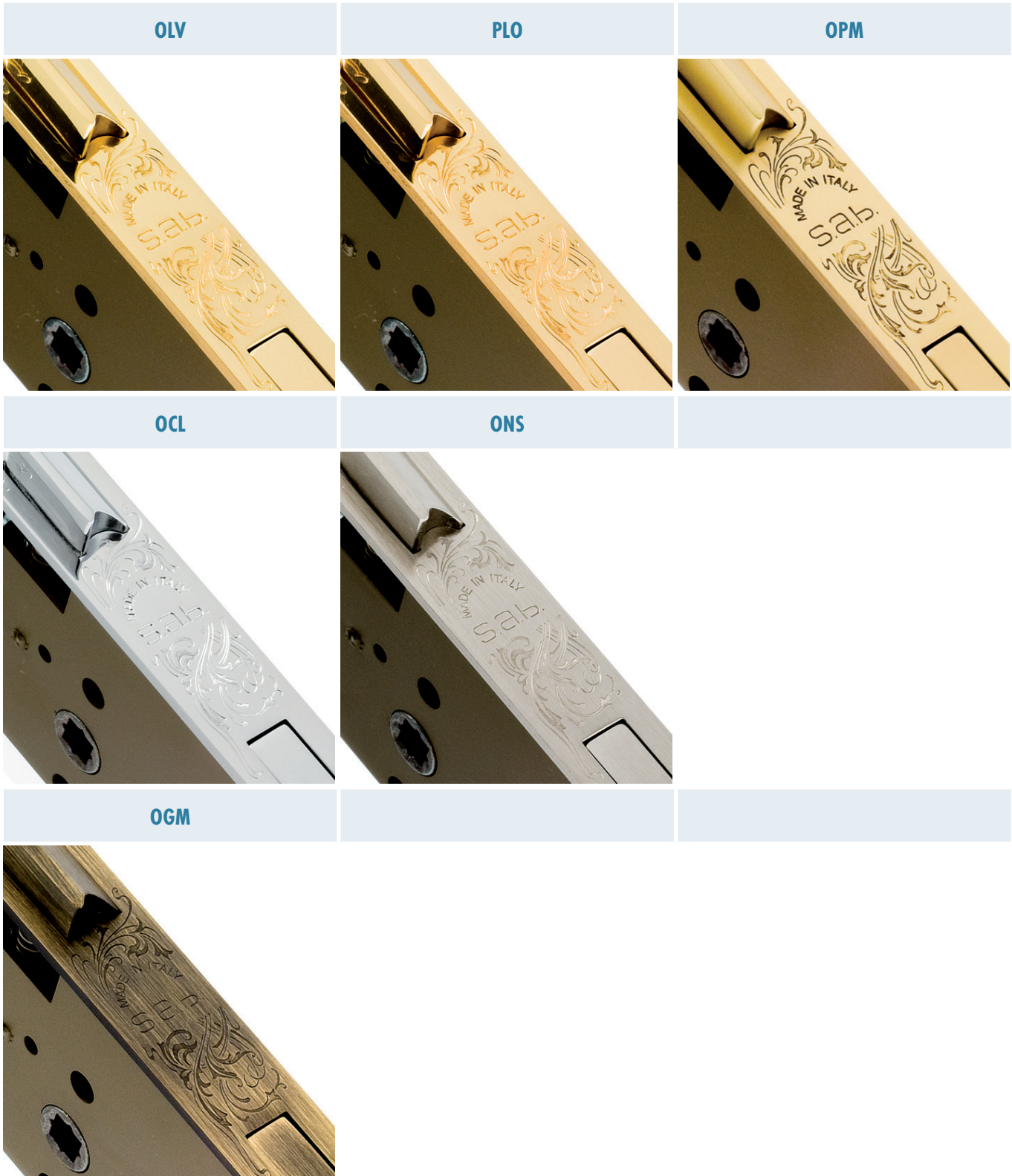

Serie
3200 Elité - LIBERTY



Serrature da infilare a cilindro | Scatola Chiusa | Stile LIBERTY
Mortice locks for profile cylinder | Closed lock case | LIBERTY Style

3200 ELITÉ - ARABIC

Catenaccio e Scrocco | Catenaccio Antistrappo e Scrocco
 Rullo Registrabile
 1-2 Mandate
 Azionamento a cilindro, quadro 8 o chiave patent

Bolt and latch | Tamper Proof Bolt and latch
 Adjustable roller
 1-2 Turns
 Cylinder movement, Square 8 or Patent Key

Piastra frontale con incisione Stile ARABIC

Frontal plate with ARABIC Style Engraving

FINITURA DI SERIE

STANDARD FINISHINGS

- Piastra frontale, Catenaccio, Scrocco o Rullo OLV

- Front plate, Bolt, Latch or Roller OLV

DOTAZIONE

ACCESSORIES

- Contropiastra con aletta Art. 357 OLV
- Vaschetta coprifresata scrocco e catenaccio Art. C371
- Viti di fissaggio
- CILINDRO ESCLUSO

- Striking plate with tab Art. 357 OLV
- Plastic bolt and latch milling cover Art. C371
- Fixing screws
- CYLINDER NOT INCLUDED

Serie **3200 Elité - ARABIC**

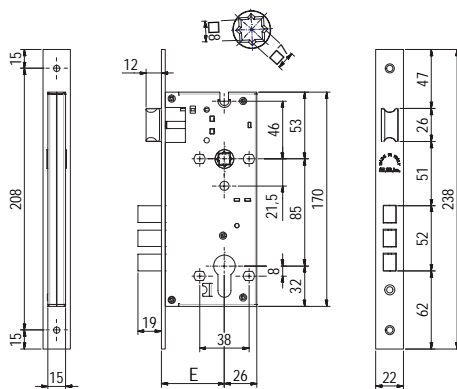

A3200/85
A3205/85

Catenaccio Antistrappo e Scrocco | 1-2 Mandate | Azionamento a cilindro | Incisione Stile ARABIC
 Tamper proof bolt and latch | 1-2 Turns | Cylinder movement | ARABIC Style Engraving

Codice Code	Finitura Finishing					
A3200 85 45 ___ 7	---					45
A3200 85 50 ___ 7	---					50
A3200 85 60 ___ 7	---	2				60
A3200 85 70 ___ 7	---					70
A3200 85 80 ___ 7	---		22x3x238	85		80
A3205 85 45 ___ 7	---					45
A3205 85 50 ___ 7	---					50
A3205 85 60 ___ 7	---	1				60
A3205 85 70 ___ 7	---					70
A3205 85 80 ___ 7	---					80

Finiture Standard | Standard Finishings

Finitura Finishing	OLV	PLO	OPM	OCL ONS	OGM

Serrature da infilare a cilindro | Scatola Chiusa | Stile ARABIC
 Mortice locks for profile cylinder | Closed lock case | ARABIC Style

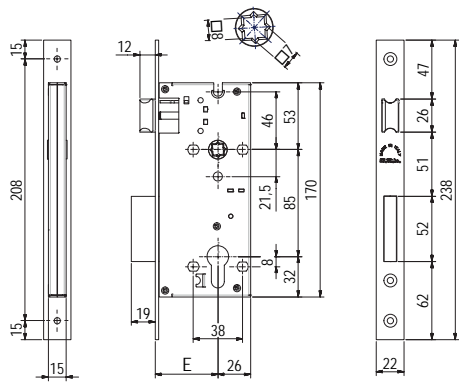

A3210/85
A3215/85

Catenaccio e Scrocco | 1-2 Mandate | Azionamento a cilindro | Incisione Stile ARABIC

Bolt and Latch | 1-2 Turns | Cylinder movement | ARABIC Style Engraving

Codice Code	Finitura Finishing					
A3210 85 40 ___ 7	---					40
A3210 85 45 ___ 7	---					45
A3210 85 50 ___ 7	---					50
A3210 85 60 ___ 7	---	2				60
A3210 85 70 ___ 7	---					70
A3210 85 80 ___ 7	---					80
A3215 85 40 ___ 7	---		22x3x238	85		40
A3215 85 45 ___ 7	---					45
A3215 85 50 ___ 7	---					50
A3215 85 60 ___ 7	---	1				60
A3215 85 70 ___ 7	---					70
A3215 85 80 ___ 7	---					80

Finiture Standard | Standard Finishings

Finitura Finishing	OLV	PLO	OPM	OCL ONS	OGM

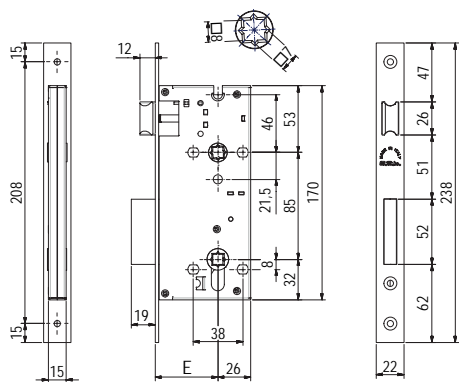

A3216/85

Serratura per bagno | Doppio quadro 8mm | Catenaccio e Scrocco | 1 Mandata | Azionamento quadro 8mm | Incisione Stile ARABIC

Bathroom lock | Double square hole 8mm | Bolt and Latch | 1 Turn | Square hole movement | ARABIC Style Engraving

Codice Code	Finitura Finishing					
A3216 85 40 ___ 7	---					40
A3216 85 45 ___ 7	---					45
A3216 85 50 ___ 7	---					50
A3216 85 60 ___ 7	---	1	22x3x238	85		60
A3216 85 70 ___ 7	---					70
A3216 85 80 ___ 7	---					80

Finiture Standard | Standard Finishings

Finitura Finishing	OLV	PLO	OPM	OCL ONS	OGM

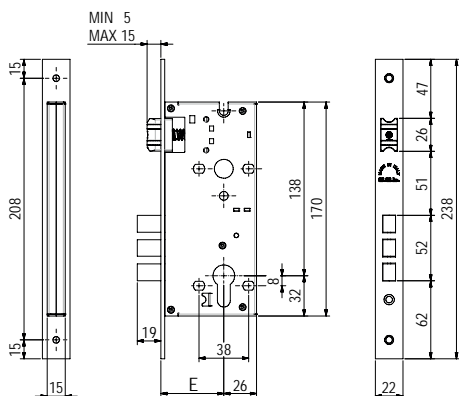

A3202
A3207

Catenaccio Antistrappo | Rullo registrabile | 1-2 Mandate | Azionamento a cilindro | Incisione Stile ARABIC

Tamper proof bolt | Adjustable roller | 1-2 Turns | Cylinder movement | ARABIC Style Engraving

Codice Code	Finitura Finishing					
A3202 45 ___ 7	---					45
A3202 50 ___ 7	---					50
A3202 60 ___ 7	---					60
A3202 70 ___ 7	---					70
A3202 80 ___ 7	---					80
A3207 45 ___ 7	---		22x3x238			45
A3207 50 ___ 7	---					50
A3207 60 ___ 7	---	1				60
A3207 70 ___ 7	---					70
A3207 80 ___ 7	---					80

Finiture Standard | Standard Finishings

Finitura Finishing	OLV	PLO	OPM	OCL ONS	OGM

Serie
3200 Elitè - ARABIC



Serrature da infilare a cilindro | Scatola Chiusa | Stile ARABIC
Mortice locks for profile cylinder | Closed lock case | ARABIC Style

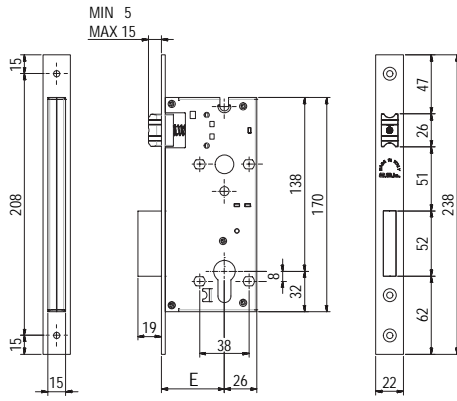

A3212 | Catenaccio | Rullo registrabile | 1-2 Mandate | Azionamento a cilindro | Incisione Stile ARABIC
A3217 | Bolt | Adjustable roller | 1-2 Turns | Cylinder movement | ARABIC Style Engraving

Codice Code	Finitura Finishing	22x3x238			
A3212 40 ___ 7				40	
A3212 45 ___ 7				45	
A3212 50 ___ 7		2		50	
A3212 60 ___ 7				60	
A3212 70 ___ 7				70	
A3212 80 ___ 7				80	
A3217 40 ___ 7				40	1
A3217 45 ___ 7				45	
A3217 50 ___ 7		1		50	
A3217 60 ___ 7				60	
A3217 70 ___ 7				70	
A3217 80 ___ 7				80	20

Finiture Standard | Standard Finishes

Finitura Finishing	OLV	PLO	OPM	OCL ONS	OGM

Versioni Speciali / Special Type

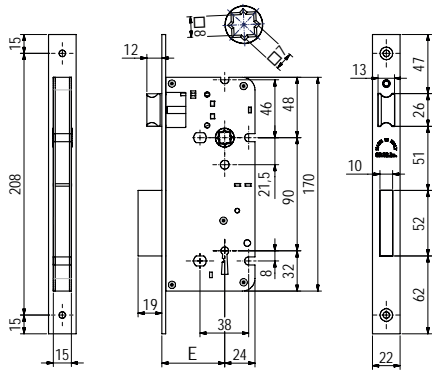

A2260/90 | Catenaccio e Scrocco | 1-2 Mandate | Azionamento con Chiave Patent | Incisione Stile ARABIC
A2265/90 | Bolt and Latch | 1-2 Turns | Patent Key movement | ARABIC Style Engraving

Codice Code	Finitura Finishing	22x3x238			
A2260 90 40 ___ 7				40	
A2260 90 45 ___ 7				45	
A2260 90 50 ___ 7		2		50	
A2260 90 60 ___ 7				60	
A2265 90 40 ___ 7			90	40	1
A2265 90 45 ___ 7				45	
A2265 90 50 ___ 7		1		50	
A2265 90 60 ___ 7				60	20

* Gli articoli A2260-A2265 sono solo con scatola aperta | Articles A2260-A2265 are available only with open lock case

Finiture Standard | Standard Finishes

Finitura Finishing	OLV	PLO	OPM	OCL ONS	OGM



Serie
3200 Elité - ARABIC



Serrature da infilare a cilindro | Scatola Chiusa | Stile ARABIC
Mortice locks for profile cylinder | Closed lock case | ARABIC Style