

TECHNICAL SHEET INVISACTA IN310

Concealed hinge for heavy doors

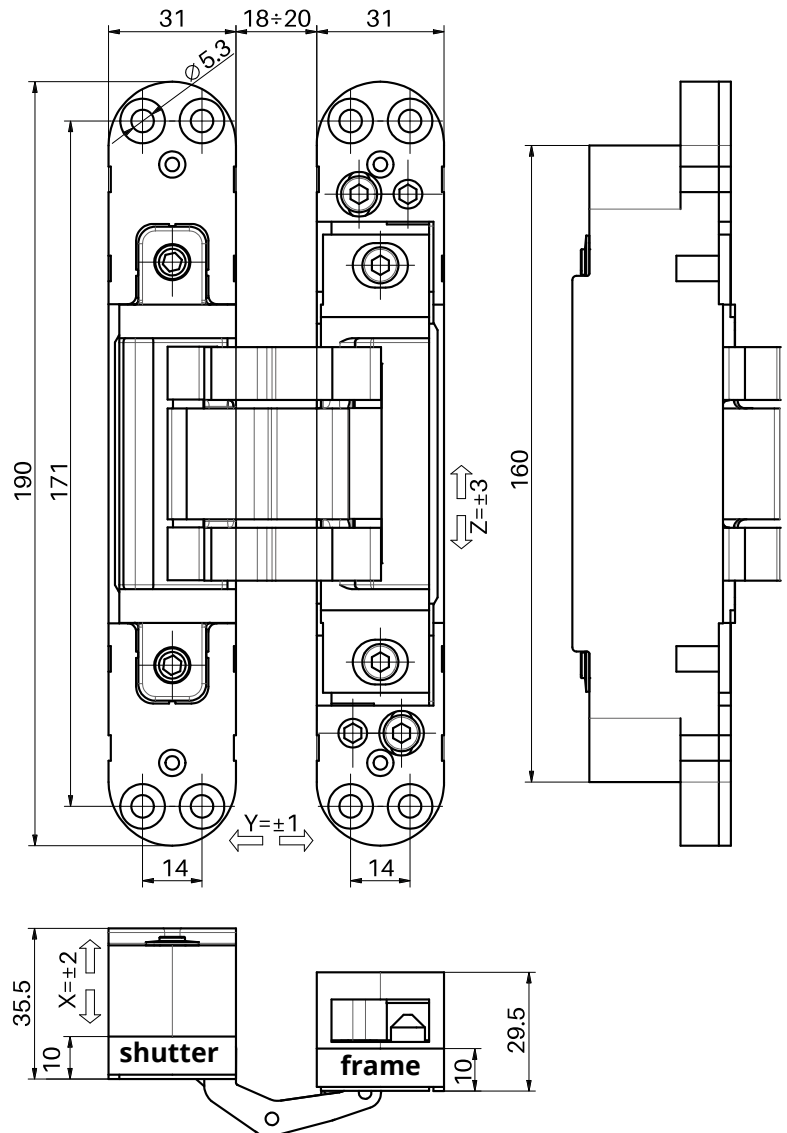

Technical features

- The hinge is suitable to be installed on doors and frames in wood and aluminium
- Material of casing: zamak.
- Material of lever: aluminium.
- The hinge can be fitted with door closing devices.
- CE certified - European Assessment Document 020001-01-0405
- Fireproof certified 90' - UNI-EN 1634-1
- Equipped with caps to conceal the screws.
- The hinge can be fitted right and left.
- Movement on 7 junction fulcrums equipped with bearing in plastic HT with high resistance and long life.
- Equipped with 3-way adjustments that can be settled by means of just one 4 mm hex-spanner.

Technical data

Capacity*	120 Kg.
Hinge height	190 mm
width shutter side	31 mm
width frame side	31 mm
Depth shutter side	35,5 mm
Depth frame side	29,5 mm
Door opening angle	180°
Side adjustment	± 2 mm
Height adjustment	± 3 mm
Depth adjustment	± 1 mm

* Tested with 90x210 cm doors - For more information on the number of hinges to be used according to the weight and dimension of the door, please see the loading charts available on the website www.otlav.it.

Accessories

Aluminium jig	MU310190G002
Nylon jig	MUINV500G006
Fixing plate	JC522310

Finishing

IN3101909N03

Matt Black plastified



IN310190V703

Satinized silver plated



IN310190VN03

Satinized Nickel Plated



IN3101909P03

White matt RAL9016



IN310190VD03

Chrome Plated



IN310190VO03

Polished gold



Milling on the shutter

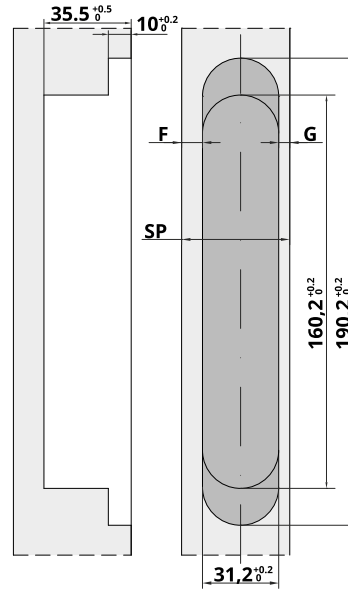

Milling on the frame

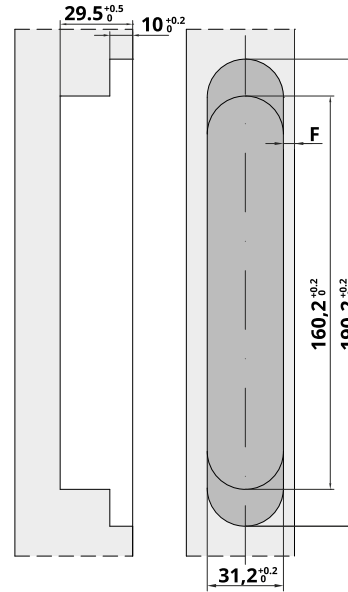

Caps

